



2 BEAUMONT CT.



bonners & babingtons

Beaumont Court
Marlow



Beaumont Court Beaumont Rise Marlow SL7 1EE

Tenure: Leasehold

Price: £500,000

Annual Service Charge: TBC

Annual Ground Rent: TBC

Tax Band: C

EIR: 73

Local Authority: BCC



Offered to the market with no onward chain, this beautifully presented two-bedroom ground floor maisonette has been fully refurbished throughout by the current owner and is finished to an exceptionally high standard. Being conveniently located just a five-minute walk from the High Street and train station, the property is ideal for commuters, first-time buyers and downsizers alike.

The accommodation comprises two well-proportioned double bedrooms, a stylish bathroom featuring a rainfall shower, and a superb open-plan kitchen, dining and sitting room. Double doors open directly onto the garden area, creating a bright and sociable living space that is perfect for both everyday living and entertaining. Outside, the property benefits from a large private driveway providing ample off-road parking, together with a generous, low-maintenance patio garden. The garden is particularly private and secluded, with mature flower beds adding to its appeal.

Marlow town centre is a thriving and stylish riverside community with a comprehensive range of shops and excellent pubs and restaurants. Nearby Marlow Station has a regular train service to London Paddington via Maidenhead (from 44 mins) with links to the City of London, via the Elizabeth Line. Access to the M4 and M40 is via the A404(M) and London Heathrow is approximately 22 miles away.

There is a wide range of educational and recreational facilities in the area. Excellent local schools are numerous and include Sir William Borlase in Marlow.





Approximate total area⁽¹⁾
614 ft²
57 m²

(1) Excluding balconies and terraces

Calculations reference the RICS IPMS 3C standard. Measurements are approximate and not to scale. This floor plan is intended for illustration only.

GIRAFFE360



bonners & babingtons

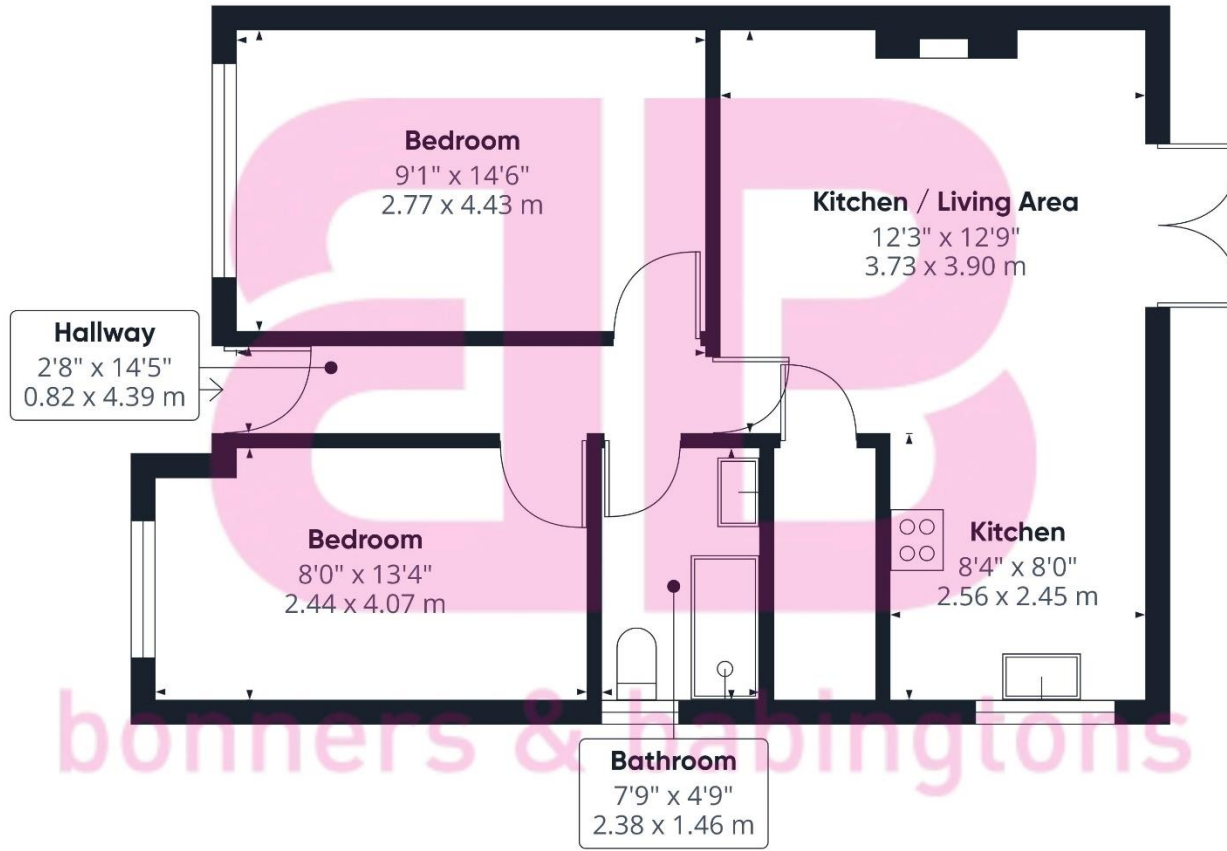

Anglers Court, Spittal Street, Marlow, Buckinghamshire, SL7 3HJ

01628 333800

marlow@bb-estateagents.co.uk



Disclaimer

We endeavour to make our particulars accurate and reliable. They are for guidance only and are intended to give a fair overall summary of the property. They do not form part of any contract or offer, and should not be relied upon as a statement or representation of fact. Measurements, areas and distances are approximate and photographs provided for guidance only. No undertaking is given as to the structural condition of the property, or any necessary consents, or the operating ability or efficiency of any service, system or appliance. Prospective purchasers must satisfy themselves with regard to each of these points. If there is any particular aspect of the property about which you would like further information, please contact us, especially, before you travel to the property. R2170