



Bristow Court
Marlow



bonners & babingtons



Bristow Court
Byron Close
Marlow
Buckinghamshire
SL7 1UF

Tenure: Freehold
Guide Price: £400,000
Local Authority: BCC
Tax Band: D
EIR: TBC



Nestled in a peaceful, traffic-free setting, this charming end-terrace home offers a wonderful opportunity to create something truly special. Brimming with potential and bathed in natural light, the property welcomes you into a spacious open-plan lounge, kitchen, and dining area—perfect for both everyday living and effortless entertaining. Flowing seamlessly from this inviting heart of the home is a delightful conservatory, where you can unwind while enjoying views over the private rear garden—a tranquil haven ideal for relaxing afternoons and alfresco gatherings.

Upstairs, three bedrooms provide comfortable accommodation for family living, complemented by a family bathroom with the added convenience of a separate W.C. Outside, the property continues to impress with its secluded garden space, offering both privacy and a blank canvas for keen gardeners or those wishing to design their own outdoor retreat. Further benefits include a garage located in a nearby block and the advantage of no onward chain, ensuring a smoother move. While some cosmetic refurbishment is required, this simply presents an exciting opportunity to personalise and enhance the home to your own taste and style. A rare find this property promises both comfort and potential—a place ready to be transformed into your dream home.



Marlow town centre is a thriving and stylish riverside community with a comprehensive range of shops and excellent pubs and restaurants. Nearby Marlow Station has a regular train service to London Paddington via Maidenhead (from 44 mins) with links to the City of London, via the Elizabeth Line. Access to the M4 and M40 is via the A404(M) and London Heathrow is approximately 22 miles away. There is a wide range of educational and recreational facilities in the area. Excellent local schools are numerous and include Sir William Borlase in Marlow.



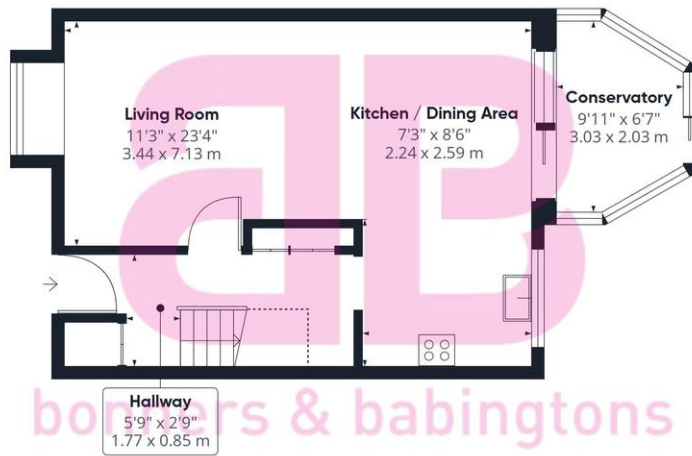

Ground Floor

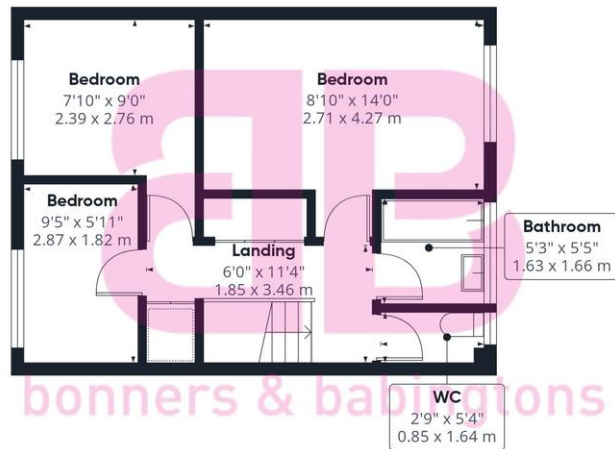

Floor 1



Approximate total area⁽¹⁾

822 ft²
76.4 m²

Reduced headroom

15 ft²
1.4 m²

(1) Excluding balconies and terraces

Reduced headroom

..... Below 5 ft/1.5 m

Calculations reference the RICS IPMS 3C standard. Measurements are approximate and not to scale. This floor plan is intended for illustration only.

GIRAFFE360



bonners & babingtons

Anglers Court, Spittal Street, Marlow, Buckinghamshire, SL7 3HJ

01628 333800

marlow@bb-estateagents.co.uk



Disclaimer

We endeavour to make our particulars accurate and reliable. They are for guidance only and are intended to give a fair overall summary of the property. They do not form part of any contract or offer, and should not be relied upon as a statement or representation of fact. Measurements, areas and distances are approximate and photographs provided for guidance only. No undertaking is given as to the structural condition of the property, or any necessary consents, or the operating ability or efficiency of any service, system or appliance. Prospective purchasers must satisfy themselves with regard to each of these points. If there is any particular aspect of the property about which you would like further information, please contact us, especially, before you travel to the property. B2170