



bonners & babingtons

Churchill Drive
Marlow

Churchill Drive
Marlow
Buckinghamshire
SL7 1TN

Tenure: Freehold

Price: £400,000

Local Authority: BCC

Tax Band: D

EIR: 70



This well-presented three-bedroom terraced house offers an excellent opportunity for first-time buyers, downsizers, or investors alike, and is available with no onward chain.

The property features a spacious lounge/diner, ideal for both relaxing and entertaining, alongside a refitted galley kitchen offering a modern and practical layout. A convenient cloakroom completes the ground floor accommodation.

Upstairs, there are three well-proportioned bedrooms served by a family bathroom. Externally, the home benefits from a private rear garden, perfect for outdoor enjoyment, as well as ample residents' parking nearby.

Combining comfortable living space with a convenient setting, this attractive home is ready to move into and must be viewed to be fully appreciated.

Marlow town centre is a thriving and stylish riverside community with a comprehensive range of shops and excellent pubs and restaurants. Nearby Marlow Station has a regular train service to London Paddington via Maidenhead (from 44 mins) with links to the City of London, via the Elizabeth Line. Access to the M4 and M40 is via the A404(M) and London Heathrow is approximately 22 miles away. There is a wide range of educational and recreational facilities in the area. Excellent local schools are numerous and include Sir William Borlase in Marlow.



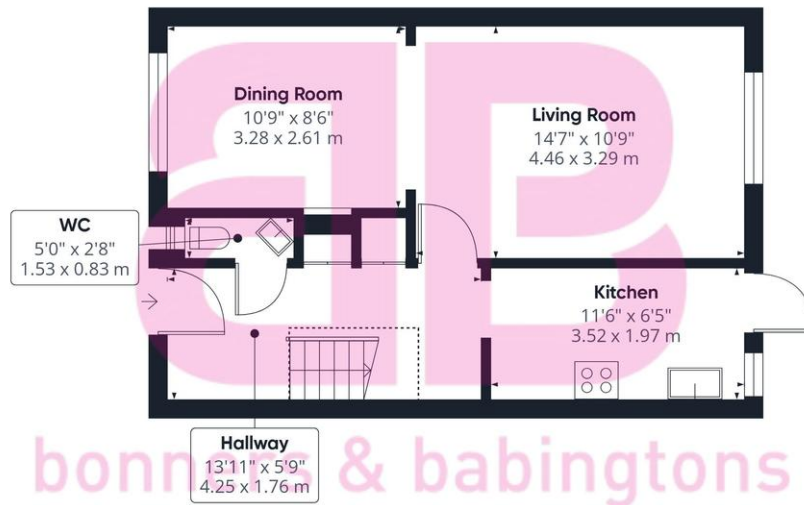

Ground Floor



Floor 1



Approximate total area⁽¹⁾

834 ft²
77.8 m²

Reduced headroom

15 ft²
1.4 m²

(1) Excluding balconies and terraces

Reduced headroom

..... Below 5 ft/1.5 m

Calculations reference the RICS IPMS 3C standard. Measurements are approximate and not to scale. This floor plan is intended for illustration only.

GIRAFFE360



bonners & babingtons

Anglers Court, Spittal Street, Marlow, Buckinghamshire, SL7 3HJ

01628 333800

marlow@bb-estateagents.co.uk



Disclaimer

We endeavour to make our particulars accurate and reliable. They are for guidance only and are intended to give a fair overall summary of the property. They do not form part of any contract or offer, and should not be relied upon as a statement or representation of fact. Measurements, areas and distances are approximate and photographs provided for guidance only. No undertaking is given as to the structural condition of the property, or any necessary consents, or the operating ability or efficiency of any service, system or appliance. Prospective purchasers must satisfy themselves with regard to each of these points. If there is any particular aspect of the property about which you would like further information, please contact us, especially, before you travel to the property. B2170