





Springfield Park Holyport Berkshire SL6 2YN

- Tenure: Freehold
- Price Guide: £700,000
- Local Authority: RBWM
- EPC Rating: D
- Council Tax Band: E



Situated in the heart of this popular village and with easy access to the M4 and a short drive to Maidenhead Train Station is this extremely well presented and extended four bedroom detached family home situated in this popular residential road. The accommodation comprises entrance hall with refitted cloakroom, good sized lounge with bay window, modern kitchen with archway to dining room and a double glazed conservatory. On the first floor there are four bedrooms (three good doubles and a single) and a refitted family bathroom with bath and separate shower cubicle. Outside there is brick paved driveway for 2-3 cars leading to an integral garage and the enclosed low maintenance rear garden benefits from a good degree of privacy.

Holyport village is located south of Maidenhead and has a number of local shops as well as several well-regarded pubs. Sporting and leisure facilities in the area include the leisure centre and sports clubs at Braywick Park, golf clubs, watersports at nearby Bray Lake, equestrian facilities and abundant countryside walks. There are a selection of well-regarded schools in both the independent and state sector in the local area. Road links are very accessible with junction 8/9 of the M4 providing access to the M25, central London, Heathrow and the West Country. Rail access to London is available via Maidenhead (2.6 miles), which is served by The Elizabeth Line.



An EXTENDED and WELL PRESENTED four bedroom DETACHED family home providing SPACIOUS AND WELL PLANNED accommodation, situated in this popular residential location.



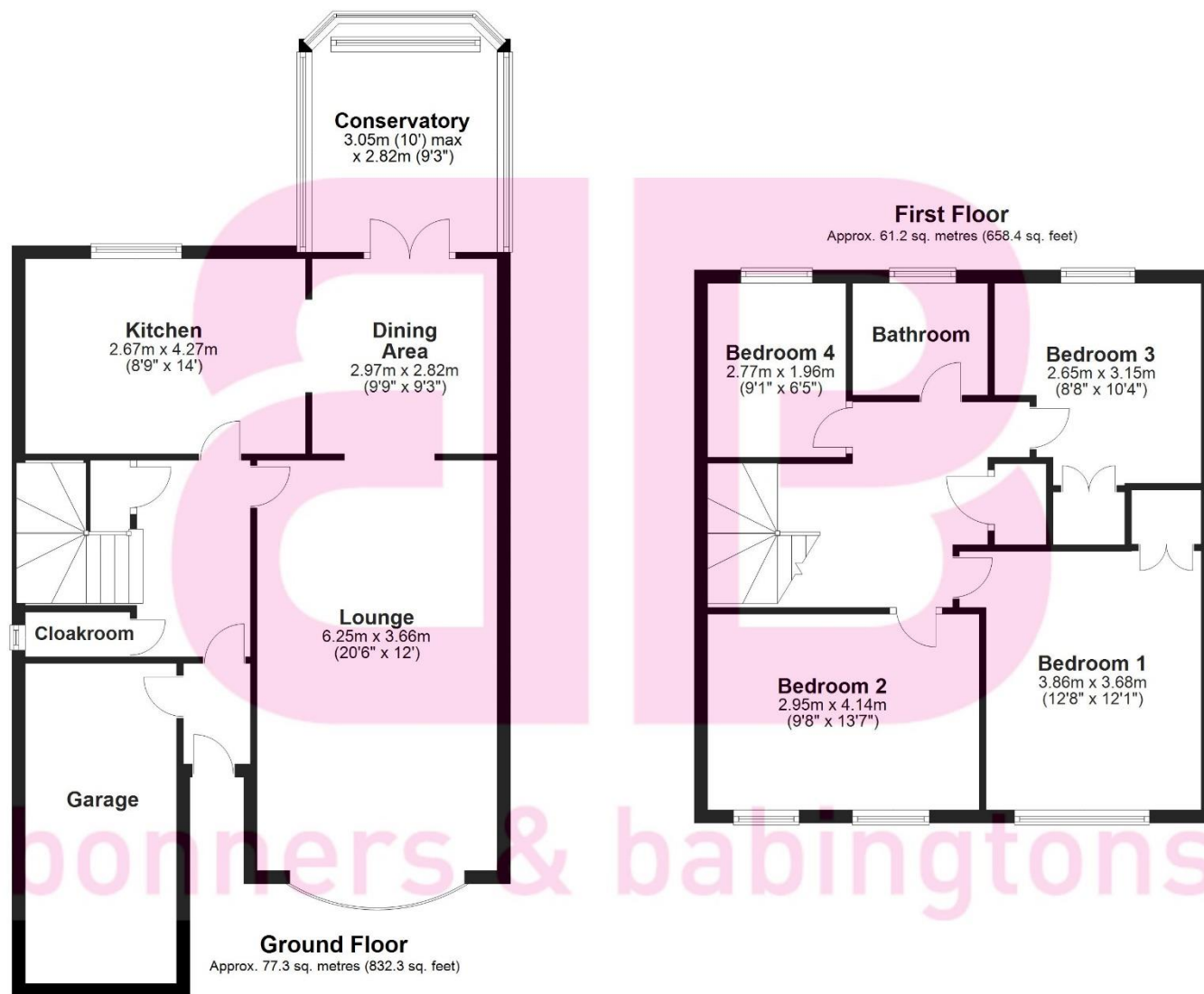

Total area: approx. 138.5 sq. metres (1490.6 sq. feet)

NOT INCLUDING OUTBUILDINGS OR GARAGE This floorplan is not to scale, it is to be used for guidance and illustrative purposes only. Accuracy is not guaranteed.
Plan produced using PlanUp.



bonners & babingtons

3 Anglers Court, Spittal Street,
Marlow, Bucks, SL7 3HJ



01628 333800

www.bb-estateagents.co.uk

Disclaimer

We endeavour to make our particulars accurate and reliable. They are for guidance only and are intended to give a fair overall summary of the property. They do not form part of any contract or offer, and should not be relied upon as a statement or representation of fact. Measurements, areas and distances are approximate and photographs provided for guidance only. No undertaking is given as to the structural condition of the property, or any necessary consents, or the operating ability or efficiency of any service, system or appliance. Prospective purchasers must satisfy themselves with regard to each of these points. If there is any particular aspect of the property about which you would like further information, please contact us, especially, before you travel to the property. B2170