



PEEL LODGE

Churchill
Retirement Living

Welcome to
PEEL LODGE
Open Tuesday to Sunday
10am to 5pm
0800 783 7661
churchillretirement.co.uk

We can
help sell
your home

Choose the
very best

What? Trust? AWARDS 2016
Householder of the Year

Show
complex
open

Thank you
for visiting
Peel Lodge

Churchill
Retirement Living
ENJOY A HASSLE
FREE MOVE
RETIREMENT
APARTMENTS
FOR SALE
Home is all this heart all
a happy retirement
0800 783 7661
churchillretirement.co.uk

BB

bonners & babingtons

Peel Lodge
Dean Street Marlow

Peel Lodge
Dean Street
Marlow
Buckinghamshire



Tenure: Leasehold

Price: £450,000

Annual Service Charge: TBC

Annual Ground Rent: TBC

Council Tax Band: D

EIR: 92

Local Authority: BCC



This beautiful apartment comes with a video entry system, fully fitted kitchen, spacious living room, separate shower room and spacious master bedroom, with fitted wardrobes and bedside draws.

The kitchen has been designed for practicality, with a fitted fridge, freezer and a waist-height oven to save bending down. The main bedroom comes complete with fitted wardrobes as well as TV and telephone points, with even the smallest details considered.

Set within beautiful landscaped grounds and located on Dean Street in Marlow, Peel Lodge is a delightful development of 30 one and two bedroom retirement apartments.

About the Development

The development's stunning Owners' Lounge with Coffee Bar, leads directly out into a patio area with landscaped gardens; both providing the perfect setting for enjoying one of the many lifestyle events with fellow Owners, or for quietly relaxing with a good book. Furthermore, the Guest Suite offers the perfect retreat for visiting family and friends.

Safety and Security:

The fully furnished Guest Suite provides an ideal space for your family and friends to stay over when visiting, while a lift to all floors is installed for your convenience.

This apartment comes complete with a 24 hour emergency Careline system, while a camera entry system is installed as standard, so you can feel safe and secure in your retirement. Intruder alarms and fire alarm systems are fitted throughout the Lodge, while a Lodge Manager is on hand to assist you with anything else you might need.

Social and Communal Lifestyle:

Communal gardens are carefully landscaped, giving you the perfect place to relax and enjoy an afternoon cup of tea, without having to worry about the maintenance and upkeep that a large garden so often demands. The carefully designed Owners' Lounge comes complete with a coffee bar and is a popular feature, providing the perfect venue for entertaining, participating in activities organised by your Lodge Manager, or just relaxing with a book. Events include everything from coffee mornings, Gin and Tonic afternoons to fitness classes, giving you the chance to socialise as much as you like throughout the year.



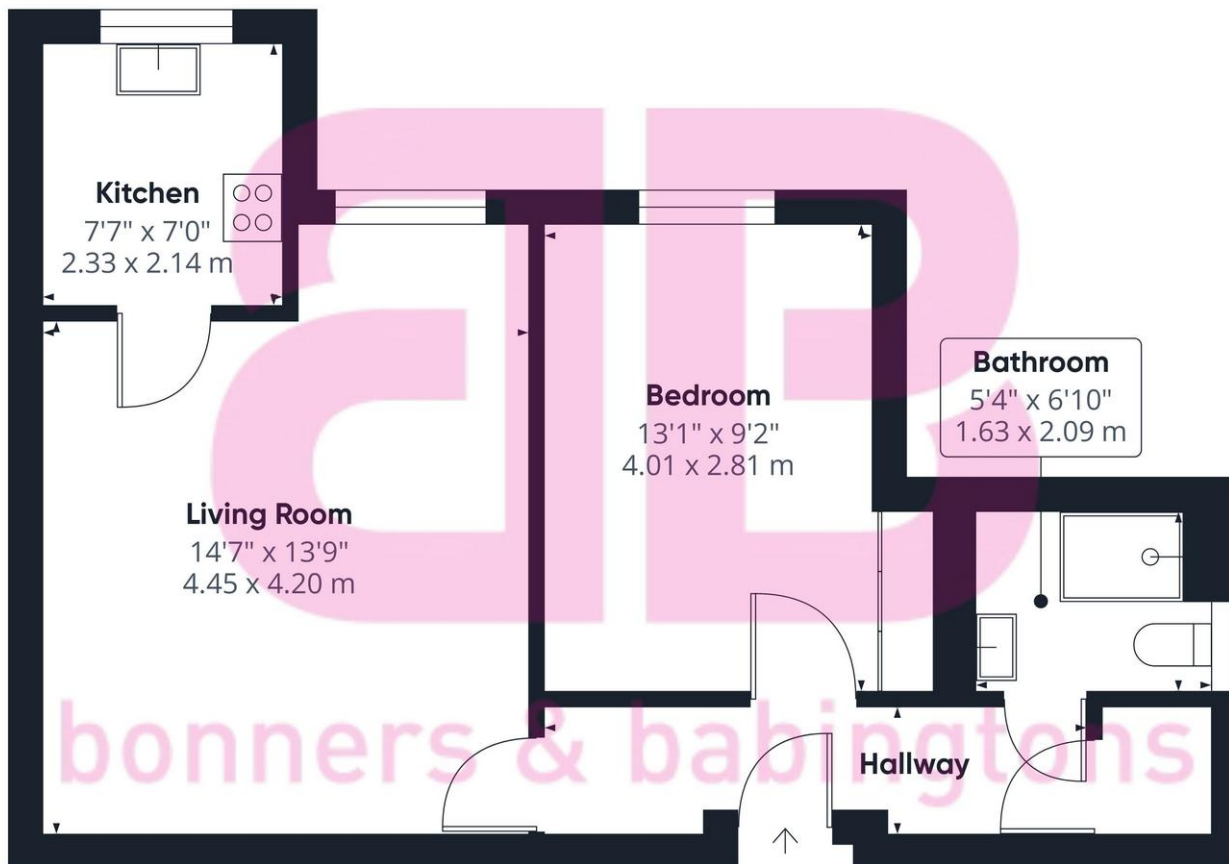

Approximate total area⁽¹⁾
520 ft²
48.2 m²

(1) Excluding balconies and terraces

Calculations reference the RICS IPMS 3C standard. Measurements are approximate and not to scale. This floor plan is intended for illustration only.

GIRAFFE360



bonners & babingtons

Anglers Court, Spittal Street, Marlow, Buckinghamshire, SL7 3HJ

01628 333800

marlow@bb-estateagents.co.uk

rightmove

OnTheMarket

Zoopla.co.uk



Disclaimer

We endeavour to make our particulars accurate and reliable. They are for guidance only and are intended to give a fair overall summary of the property. They do not form part of any contract or offer, and should not be relied upon as a statement or representation of fact. Measurements, areas and distances are approximate and photographs provided for guidance only. No undertaking is given as to the structural condition of the property, or any necessary consents, or the operating ability or efficiency of any service, system or appliance. Prospective purchasers must satisfy themselves with regard to each of these points. If there is any particular aspect of the property about which you would like further information, please contact us, especially, before you travel to the property. B2170