



BB

barnes & barnington

The Acre
Marlow

The Acre
Marlow
Buckinghamshire
SL7 1UD

- Tenure: Freehold
- Price: OIEO £550,000
- Local Authority: BCC
- EPC Rating: TBC
- Council Tax Band D



ATTENTION FIRST TIME BUYERS! This three bedroom semi detached family home is ready to move into and is available with no onward chain! On entering the property there is a spacious entrance hall with doors to kitchen and living room plus stairs to first floor. The kitchen has an array of wall and base units with work surfaces over, space and services for appliances and door to rear garden. Moving into the living room this spacious part of the accommodation is full of light and has access to the conservatory to the rear. Moving upstairs there are three good sized bedrooms, a family bathroom and a separate w.c, plenty of room for the family.

To the outside of the property there is a lovely sized corner garden with side access and patio area ideal for alfresco dining. To the front there is a large driveway with ample parking and a good sized garage that could be easily converted for further residential accommodation (STPP).

Marlow town centre is a thriving and stylish riverside community with a comprehensive range of shops and excellent pubs and restaurants. Nearby Marlow Station has a regular train service to London Paddington via Maidenhead (from 44 mins) with links to the City of London, via the Elizabeth Line. Access to the M4 and M40 is via the A404(M) and London Heathrow is approximately 22 miles away. There is a wide range of educational and recreational facilities in the area. Excellent local schools are numerous and include Sir William Borlase in Marlow.

BONNERS & BABINGTONS offer -
Situated in a pleasant and secluded cul-de-sac to the south of Marlow this three bedroom semi detached family home is available with no onward chain.



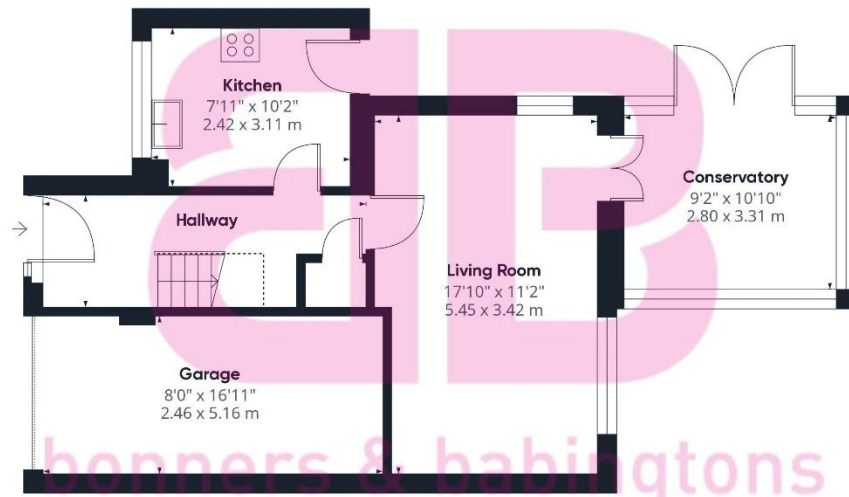

Ground Floor

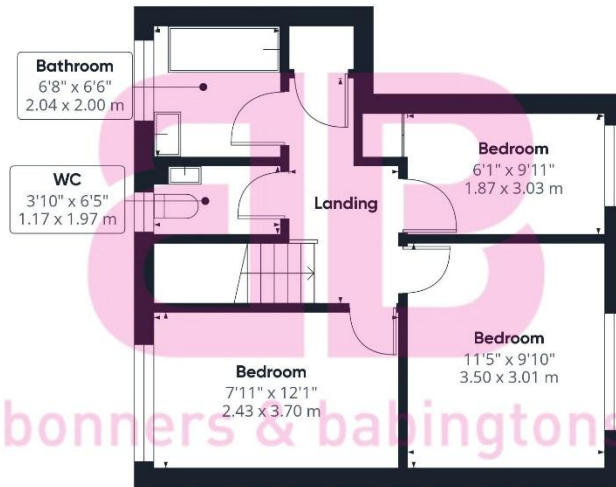

Floor 1



Approximate total area⁽¹⁾

1020.32 ft²
94.79 m²

Reduced headroom

14.05 ft²
1.31 m²

(1) Excluding balconies and terraces

Reduced headroom
..... Below 5 ft/1.5 m

While every attempt has been made to ensure accuracy, all measurements are approximate, not to scale. This floor plan is for illustrative purposes only.

Calculations were based on RICS IPMS 3C standard. Please note that calculations were adjusted by a third party and therefore may not comply with RICS IPMS 3C.

GIRAFFE360



bonners & babingtons

3 Anglers Court, Spittal Street,
Marlow, Bucks, SL7 3HJ



01628 333800

www.bb-estateagents.co.uk

Disclaimer

We endeavour to make our particulars accurate and reliable. They are for guidance only and are intended to give a fair overall summary of the property. They do not form part of any contract or offer, and should not be relied upon as a statement or representation of fact. Measurements, areas and distances are approximate and photographs provided for guidance only. No undertaking is given as to the structural condition of the property, or any necessary consents, or the operating ability or efficiency of any service, system or appliance. Prospective purchasers must satisfy themselves with regard to each of these points. If there is any particular aspect of the property about which you would like further information, please contact us, especially, before you travel to the property. B2170