



bonners & babingtons

James Close  
Marlow

James Close  
Marlow  
Buckinghamshire  
SL7 1TS

- 
- Tenure:- Leasehold
  - Guide Price: £280,000
  - Lease Length: 87 years
  - Service Charge: £326 p/a
  - Ground Rent: £10 p/a
  - Council Tax Band: C
  - EPC Rating: C



A light and airy two bedroom first floor maisonette situated in a cul-de-sac within about one mile from Marlow High Street. The property has been refurbished in recent years and accommodation includes lounge/diner, refitted kitchen, two bedrooms and family bathroom. Externally there are residents' parking bays and an enclosed rear garden with a southerly aspect. The property also benefits from gas central heating and double glazed windows.

Marlow town centre is a thriving and stylish riverside community with a comprehensive range of shops and excellent pubs and restaurants. Nearby Marlow Station has a regular train service to London Paddington via Maidenhead (from 1hr 5 mins) with links to the City of London, further enhanced when Crossrail opens in Maidenhead. Access to the M4 and M40 is via the A404(M) and London Heathrow is about 22 miles away.

There is a wide range of educational and recreational facilities in the area. Excellent local schools are numerous and include Sir William Borlase in Marlow.

A SPACIOUS and extremely well presented TWO Bedroom first floor MAISONETTE which has been REFURBISHED in recent years & benefits from its own southerly aspect GARDEN. The property is situated in a CUL-DE-SAC with residents' PARKING & is about one mile from Marlow Town Centre.



## Ground Floor

Approx. 60.3 sq. metres (649.0 sq. feet)

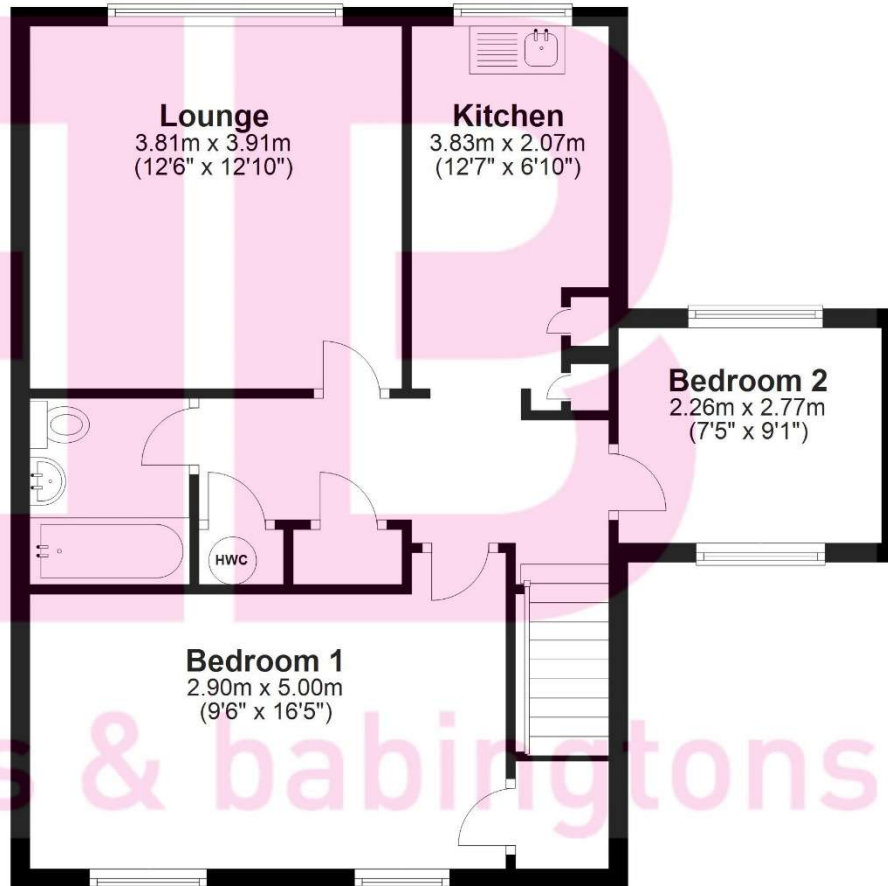

## Ground Floor

Approx. 3.2 sq. metres (34.4 sq. feet)



Total area: approx. 63.5 sq. metres (683.5 sq. feet)

NOT INCLUDING OUTBUILDINGS OR GARAGE This floorplan is not to scale. It is to be used for guidance and illustrative purposes only. Accuracy is not guaranteed. Plan produced using PlanUp.

3 Anglers Court, Spittal Street,  
Marlow, Bucks, SL7 3HJ



01628 333800

www.bb-estateagents.co.uk

### Disclaimer

We endeavour to make our particulars accurate and reliable. They are for guidance only and are intended to give a fair overall summary of the property. They do not form part of any contract or offer, and should not be relied upon as a statement or representation of fact. Measurements, areas and distances are approximate and photographs provided for guidance only. No undertaking is given as to the structural condition of the property, or any necessary consents, or the operating ability or efficiency of any service, system or appliance. Prospective purchasers must satisfy themselves with regard to each of these points. If there is any particular aspect of the property about which you would like further information, please contact us, especially, before you travel to the property. B2170



bonners & babingtons